

PT-EP14: Underwater Case System Chart

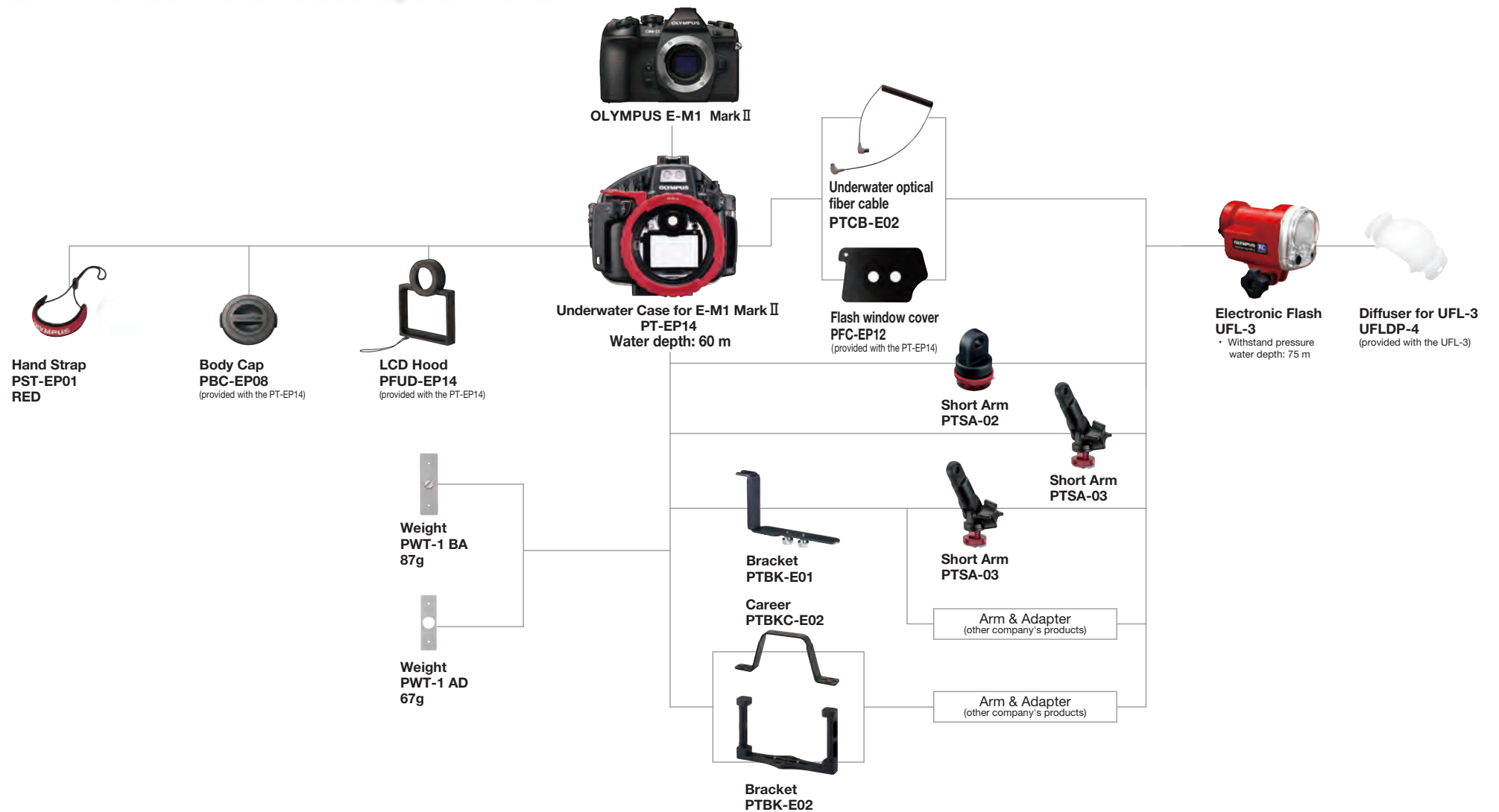

Consumables for PT-EP14 Underwater Cases



Underwater Lens Port - Lens System Chart

Lens Series	Lens	Focusing Gear Zoom Gear	Antireflective Ring Light Shield Ring	Underwater Lens Port								Options	
				PPO-EP01 Water depth: 45 m	PPO-EP02 Water depth: 60 m	PPO-EP03 Water depth: 60 m	Underwater Port Adapter for E-Series Water depth: 45 m	Underwater Port Extension Ring	PPO-E04 Water depth: 60 m	PPO-E02 Water depth: 60 m	PPO-E03 Water depth: 60 m	Adapter	Macro Conversion Lens Water depth: 40 m
M.ZUIKO PRO	M.ZUIKO DIGITAL ED 7-14mm F2.8 PRO	PPZR-EP06					PAD-EP08	PER-E01	PPO-E04				
	M.ZUIKO DIGITAL ED 12-40mm F2.8 PRO	PPZR-EP04	Anti-reflecting ring cannot be not used				PAD-EP08	PER-E01	PPO-E04				
	M.ZUIKO DIGITAL ED 8mm F1.8 Fisheye PRO	PPZR-EP05	POSR-EP10		PPO-EP02					PPO-E02 (Discontinued)			
M.ZUIKO PREMIUM	M.ZUIKO DIGITAL ED 12mm F2.0		POSR-EP08		PPO-EP02		PAD-EP08		PPO-E04				
	M.ZUIKO DIGITAL 25mm F1.8		POSR-EP09	PPO-EP01	PPO-EP02						PMLA-EP01	PTMC-01 ²	
	M.ZUIKO DIGITAL 45mm F1.8		POSR-EP03	PPO-EP01							PMLA-EP01	PTMC-01 ²	
	M.ZUIKO DIGITAL ED 30mm F3.5 Macro	PPZR-EP07	POSR-EP11	PPO-EP01	Diffuser ⁸ PPODP-EP03	PPO-EP03							
	M.ZUIKO DIGITAL ED 60mm F2.8 Macro	PPZR-EP03		PPO-EP01	PPO-EP02						PMLA-EP01	PTMC-01 ²	
						Diffuser ⁸ PPODP-EP03	PPO-EP03						
					PPO-EP01								
	M.ZUIKO DIGITAL ED 75mm F1.8			PPO-EP01							PMLA-EP01	PTMC-01 ²	
	M.ZUIKO DIGITAL ED 9-18mm F4.0-5.6	PPZR-EP02	POSR-EP02	PPO-EP01	PPO-EP02								
	M.ZUIKO DIGITAL ED 12-50mm F3.5-6.3 EZ ¹			PPO-EP01							PMLA-EP01	PTMC-01 ²	
M.ZUIKO DIGITAL 14-42mm F3.5-5.6 IIR	PPZR-EP02	POSR-EP03	PPO-EP01							PMLA-EP01	PTMC-01 ²		
ZUIKO	ZUIKO DIGITAL ED 8mm F3.5 Fisheye ³						PAD-EP08	PER-E01	PPO-E04				
	ZUIKO DIGITAL ED 50mm F2.0 Macro ³						PAD-EP08	PER-E01		PPO-E03			
Options Separately available consumables				Rear Port Cap ⁴ PRPC-EP01	Rear Cap ⁵ PRPC-EP02	Rear Cap ⁶ PRPC-EP02							
				Body Cap ⁴ PBC-EP01	Front Cover ⁵ PBC-EP02								
				Port Cover PJKT-EP03		Lens Cap ⁸ PRLC-17							
				O-ring ⁴ POL-E301	O-ring ⁵ POL-E301	O-ring ⁶ POL-E301	O-ring ⁷ POL-E301	O-ring ⁷ POL-E101	O-ring ⁷ POL-E101	O-ring ⁷ POL-E101	O-ring ⁷ POL-E101		

¹ Automatically when the camera mode is set to UW wide mode, the zoom position moves to WIDE, and when the camera mode is set to UW macro mode, the zoom position moves to TELE. Set the lens zoom ring to "E-ZOOM."
Effective when the camera firmware is Version 1.2 or later.(PT-EP08 only)

² The tip is provided with a 67 mm diameter filter thread for stacking with other lens filter or lens.

³ Fourthirds adapter MMF-3 is required to use ZUIKO DIGITAL lenses.

⁴ Provided with the PPO-EP01

⁵ Provided with the PPO-EP02

⁶ Provided with the PPO-EP03

⁷ Provided with each port

⁸ Optionally available. Required when the E-M1 Mark II's provided flash (FL-LM3) is used.